

X2

TRANSPONDER

QUICK START GUIDE



IMPORTANT!

Before you mount your X2 Transponder to your vehicle, make sure you:

- ▶ Register your X2 Transponder to your account
- ▶ Activate the subscription on your X2 Transponder

Without these 2 steps your X2 Transponder will NOT work

REGISTER

1 LOGIN / SIGN UP

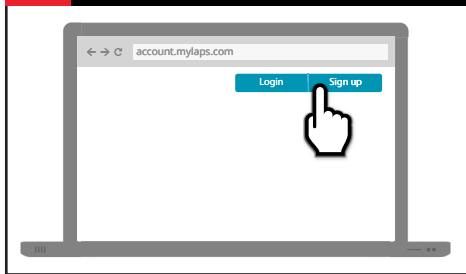

Go to account.mylaps.com

WHAT'S IN THE BOX?

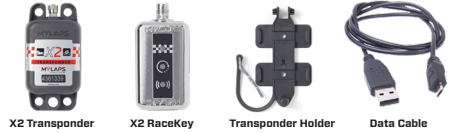

X2 Transponder

X2 RaceKey

Transponder Holder

Data Cable

Extra accessories for Direct Power X2 Transponder



Transponder to RaceKey Mount Cable

RaceKey to 12VDC power source cable

X2 RaceKey Mount

2 REGISTER TRANSPONDER

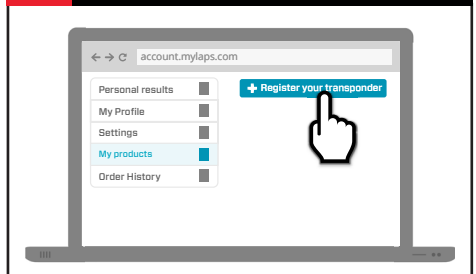

3 ENTER TRANSPONDER NUMBER

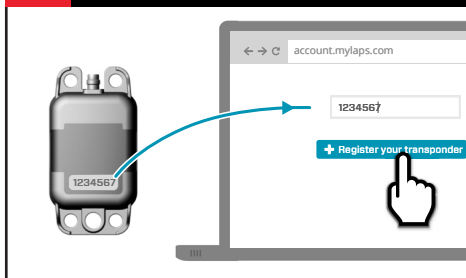

4 CLICK ON MANAGE PRODUCT

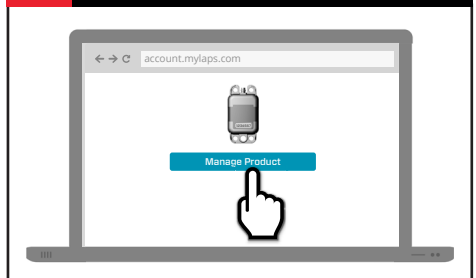

IN CASE YOU ENCOUNTER ANY ISSUES, PLEASE CONTACT YOUR LOCAL OFFICE

MYLAPS EMEA Office
Haarlem, The Netherlands
☎ +31 (0)23 760 0100
✉ info@mylaps.com

MYLAPS Americas Office
Atlanta, USA
☎ +1 678 816 4000
✉ info.americas@mylaps.com

ACTIVATE

5

DOWNLOAD MYLAPS CONNECT SOFTWARE

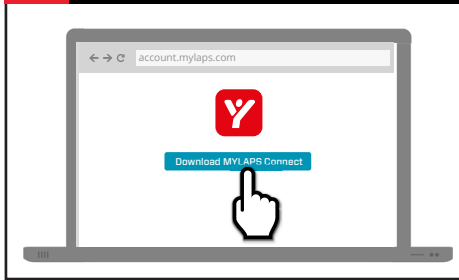

Log in with same account details

6

CONNECT X2 RACEKEY TO COMPUTER

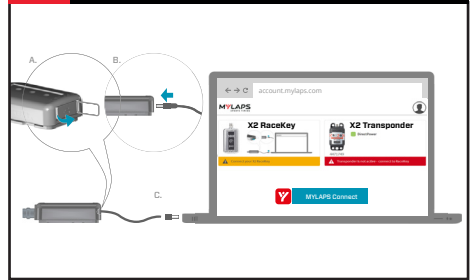

7

LEDS ON RACEKEY TURN BLUE

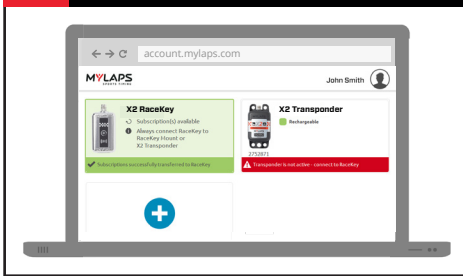

8

CONNECT X2 RACEKEY TO TRANSPONDER

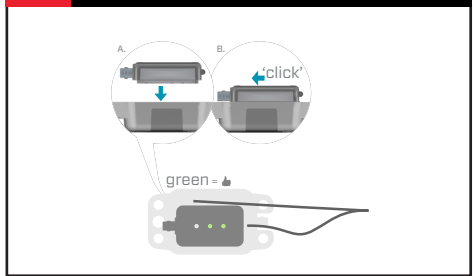

9

TRANSPONDER ACTIVATED

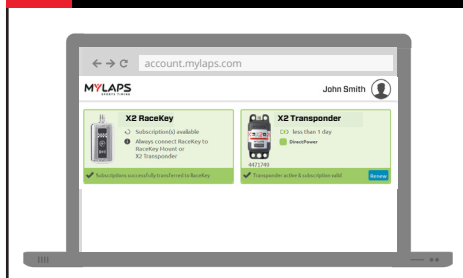

10

CHARGING TRANSPONDER

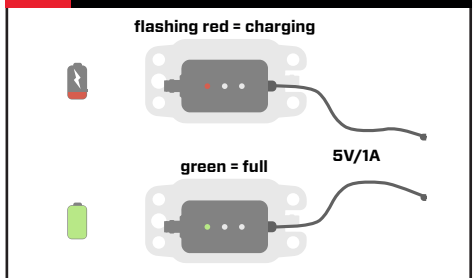

4 hours charging = 5 days racing

MYLAPS Japan Office

Tokyo, Japan

☎ +81 3 6418 8209

✉ info.japan@mylaps.com

MYLAPS APAC Office

Sydney, Australia

☎ +61 2 9533 1100

✉ info.asia.pacific@mylaps.com

MYLAPS Asia Office

Selangor, Malaysia

☎ +60 3 5613 1235

✉ info.asia@mylaps.com

11 FINAL CHECK



After disconnecting transponder and RaceKey, check the top of the transponder.

4 times flashing green = 5 days racing
3 times flashing green = 4 days racing
2 times flashing green = 3 days racing
1 time flashing green = 2 days racing

Flashing red = battery for less than 1 day

MOUNT



BIKE & MX

12A MOUNT TRANSPONDER TO BIKE / MX

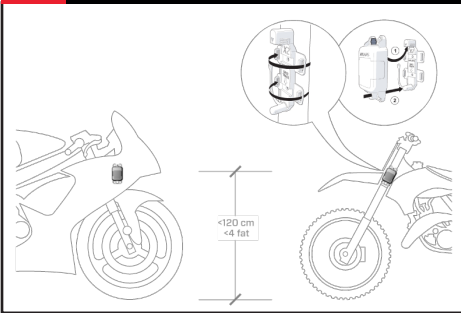

CAR & KART

12B MOUNT TRANSPONDER TO CAR / KART

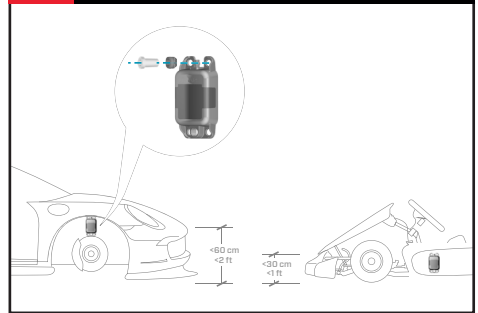

FOR DIRECT POWER TRANSPONDERS ONLY

13 MOUNT RACEKEY MOUNT

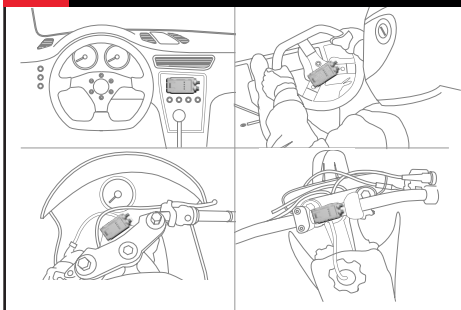

14 CONNECT RACEKEY

